

# Venue Information



## Stadthalle Offenbach

Stadthalle Offenbach Veranstaltungs GmbH  
Waldstr. 312  
D - 63071 Offenbach am Main

Phone +49 (0)69 - 829002-20  
Fax +49 (0)69 - 829002-62

Homepage [www.stadthalle-offenbach.de](http://www.stadthalle-offenbach.de)  
Email [info@stadthalle-offenbach.de](mailto:info@stadthalle-offenbach.de)

General Manager Birgit von Hellborn  
Technical Manager Philip Gartmann  
Project management Sabrina Krause, Jasmina Hasikic





## Stadthalle Offenbach

### Big Hall



#### Dimensions

Length	28,00 m
Width	48,00 m
Height ca.	7,00 m
overall m <sup>2</sup>	1.150 m <sup>2</sup>

#### Exhibition space

net	750 m <sup>2</sup>
-----	--------------------

#### biggest Loadingdoor to the hall

Width	3,00 m
Height	2,70 m

#### Maximum capacity

##### without chairs

4.000 persons  
*less wheel chair platform  
(at least 40 persons)  
as well as FOH and stage ditch*

##### chairs in row incl. balcony

small stage	1.948 persons	<i>(incl. 20 wheel chair seats, less FOH)</i>
big stage	1.773 persons	<i>(incl. 18 wheel chair seats, less FOH)</i>

If you need alternative chair models e.g. round or angled banquet, parliamentary or for a sportive event (incl. or not including our tribune on the left and right hand of the stage) please do not hesitate to contact us and we will sent you the corresponding plans.

##### balcony

consists of 436 constant integrated chairs in row

##### tribune

on the right and left hand of the stage with 169 seats each



## Stadthalle Offenbach



### Stage

constant stage	Width	18,00 m
	Depth	3,50 m
	Height	1,25 m
	Clear Height	6,90 m
	(stage upper edge, bottom edge steel charge carrier)	
forestage		
hydraulic lifting platform	Width	18,00 m
	Depth	5,50 m
	Height	maximum 1,25 m
	Clear Height	6,90 m
	(stage upper edge, bottom edge steel charge carrier)	
	ultimate load	10 tons (but maximum 500kg/m <sup>2</sup> )
maximum stage dimensions	constant stage + forestage	18,00m x 9,00m
side stage	build up with platform available on application	
curtains (anthracite)	backdrop 2x	6,00m x 9,00m
	panorama 2x	6,00m x 9,00m
	drop scene 2x	6,00m x 9,00m
platform planking	parquet (stage borer or nails forbidden)	
drawing floor	not existing	
screen	5,00m x 6,00m can be installed on application price on application	



## Stadthalle Offenbach

rigging points	- see riggingplan - only at the stagearea - with max. 1.000kg/Point resilient - all in all maximum 9 tons in the stage area, but maximum 3 x 1 tons per charge carrier - plus 4 tons at the charge carrier of the stage front angle
bars	8 x BGV - C1 electric chain hoist by Chainmaster - ultimate load per piece 500 kg - speed 5m/minute - price on application
trass	- 4 x 16 m Global Trass F34 P - price on application
access to the stage	possible to access the stage unseen from the backstage area accessible from both sides by stairs
elevator to the stage	- no elevator existing - stage is lockable on 4 floors (not scenic): Hall floor; 0,25 m, 1,00 m; 1,25 m
stage light	ADB Tenor, "Computerstellwerk" und MA Light Commander 24/6 - working light - 8 x 6er Bar Par 64, CP 61
light in front of the stage	techno profile, height adjustable with 12 x 2 kw profiler
electrical connection on stage	right 5 grounding receptacle 220 V / 16 A, directly 5 grounding receptacle 220 V / 16 A, dimmable 7 Eberle electrical stage sockets 220 V / 16 A, dimmable centered 5 grounding receptacle 220 V / 16 A, directly left 5 grounding receptacle 220 V / 16 A, directly 5 grounding receptacle 220 V / 16 A, dimmable 7 Eberle electrical stage sockets 220 V / 16 A, dimmable 1 CEE electrical socket 32 A, 5polig back 12 Harting backfills à 6 channels



## Stadthalle Offenbach



electrical connection for  
the stage

right (*light*)

1 x 315 A	open 5pole
1 x 125 A	CEE 5pole
2 x 63 A	CEE 5pole
2 x 32 A	CEE 5pole
3 x 16 A	CEE 5pole

**all in all maximum:**

**315A**

left (*sound*)

1 x 125 A	open 5pole
1 x 125 A	CEE 5pole
1 x 63 A	CEE 5pole
1 x 32 A	CEE 5pole
1 x 16 A	CEE 5pole

**all in all maximum:**

**160A**

### Loading way to the stage

loading platform for trucks  
Delivery for trucks  
distance to the stage

not available  
at the truck loading area  
about 30 m (off the hall at ground level)

### Backstage

(all dressing rooms and production offices are lockable individually)

dressing rooms first floor

3 VIP dressing rooms with shower and toilet  
1 DSL cable, in all rooms available by W-Lan  
2 dressing rooms with fridge

production offices  
ground floor

- 5 rooms, also useable as dressing rooms  
  
- 1 DSL cable, in all rooms available by W-LAN  
- all rooms have a phone and fax connection  
- all rooms have a safe  
- toilets and showers on the corridor

catering

- 1 room for about 30 persons  
- sink, cooker and 2 fridges available



## Stadthalle Offenbach

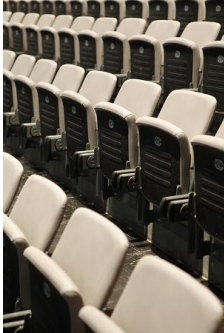

### More information on our venue:

house light	<ul style="list-style-type: none"><li>- HQI composition and advance as well as exhibition light</li><li>- dimmable halogen bulbs</li></ul>
spots	<ul style="list-style-type: none"><li>- 2 Spotlights Vedette MSR 1.200, cold restrike, 1.200 W with colour changer</li><li>- on the right and left hand of the stage direction</li><li>- price on application</li></ul>
sound system	<ul style="list-style-type: none"><li>- Audio "Variant" Aktives Line Array von DAS</li><li>- 1 x Variant 18A Bass und 4 x Variant 25A on the right and left</li><li>- 1 Mittel Cluster, 2 x Variant 25A</li><li>- 4 x Electro Voice Bass speakers, 2 x 18" MT series</li><li>- 1 x DAS Controller DSP - 3VS</li></ul>
mixing desk	Allen & Heath GLD 80 with 24:12 digital multicore
Multicore	36 constant installed entries at the stage for the house system, not free useable
pyrotechnics	only after severally agreement with the fire department and building inspection
box office	<ul style="list-style-type: none"><li>- no W-Lan available</li><li>- phone and fax connections available</li></ul>



## Stadthalle Offenbach

### New foyer



Size	ca. 350 m <sup>2</sup>	
maximum capacity	banquet angled banquet round chairs in a row parlamentary	230 persons 160 persons 350 persons 130 persons
telephone connection	3 x available	
fax connection	1 x available	
ISDN connection	1 x available	
screen	2,00 m x 3,00 m	
beamer	1 x available	
sound system	2 x Electro Voice SX 200 active	



# Stadthalle Offenbach

## Ground view:

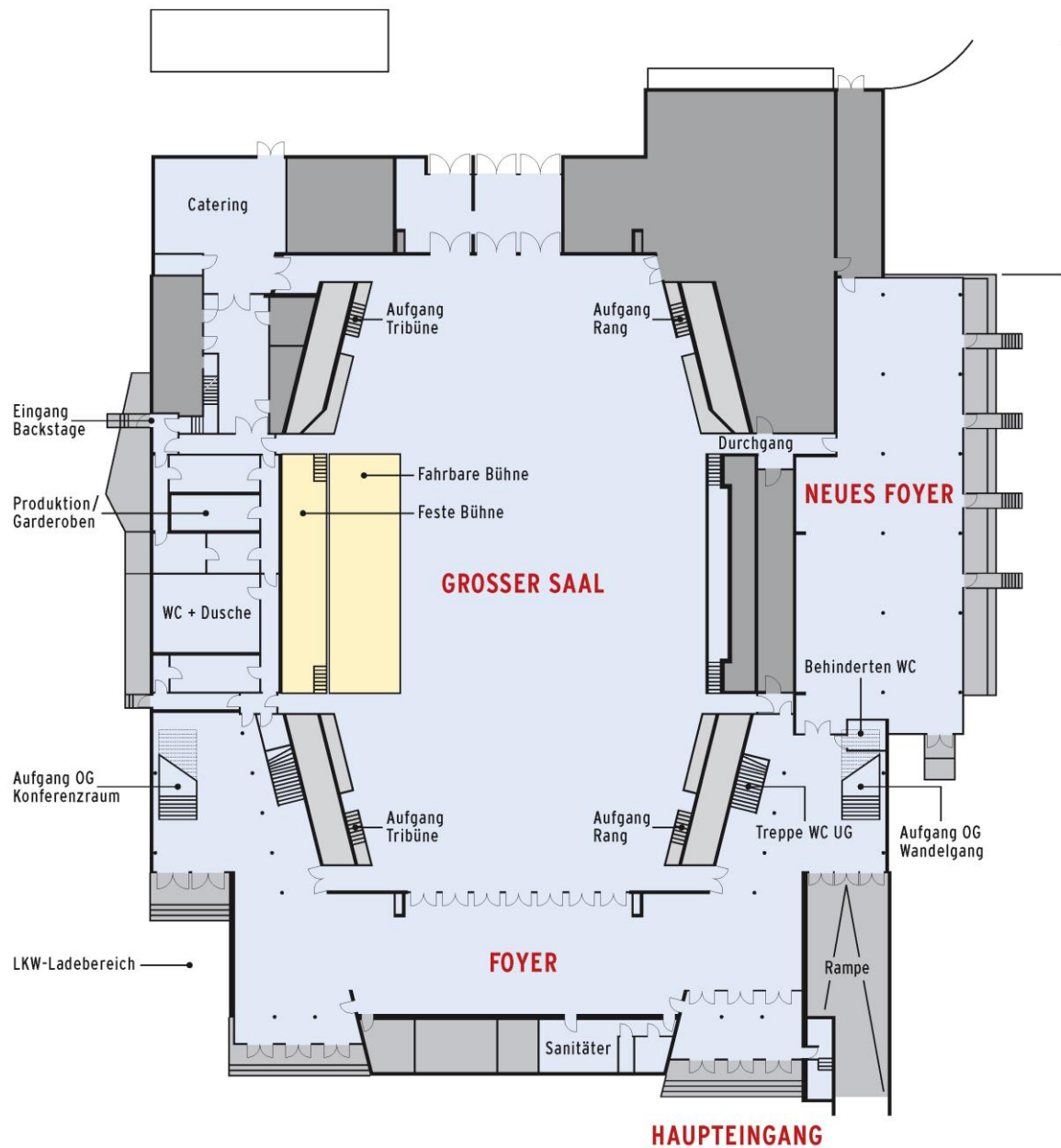



# Stadthalle Offenbach

## Riggingplan:

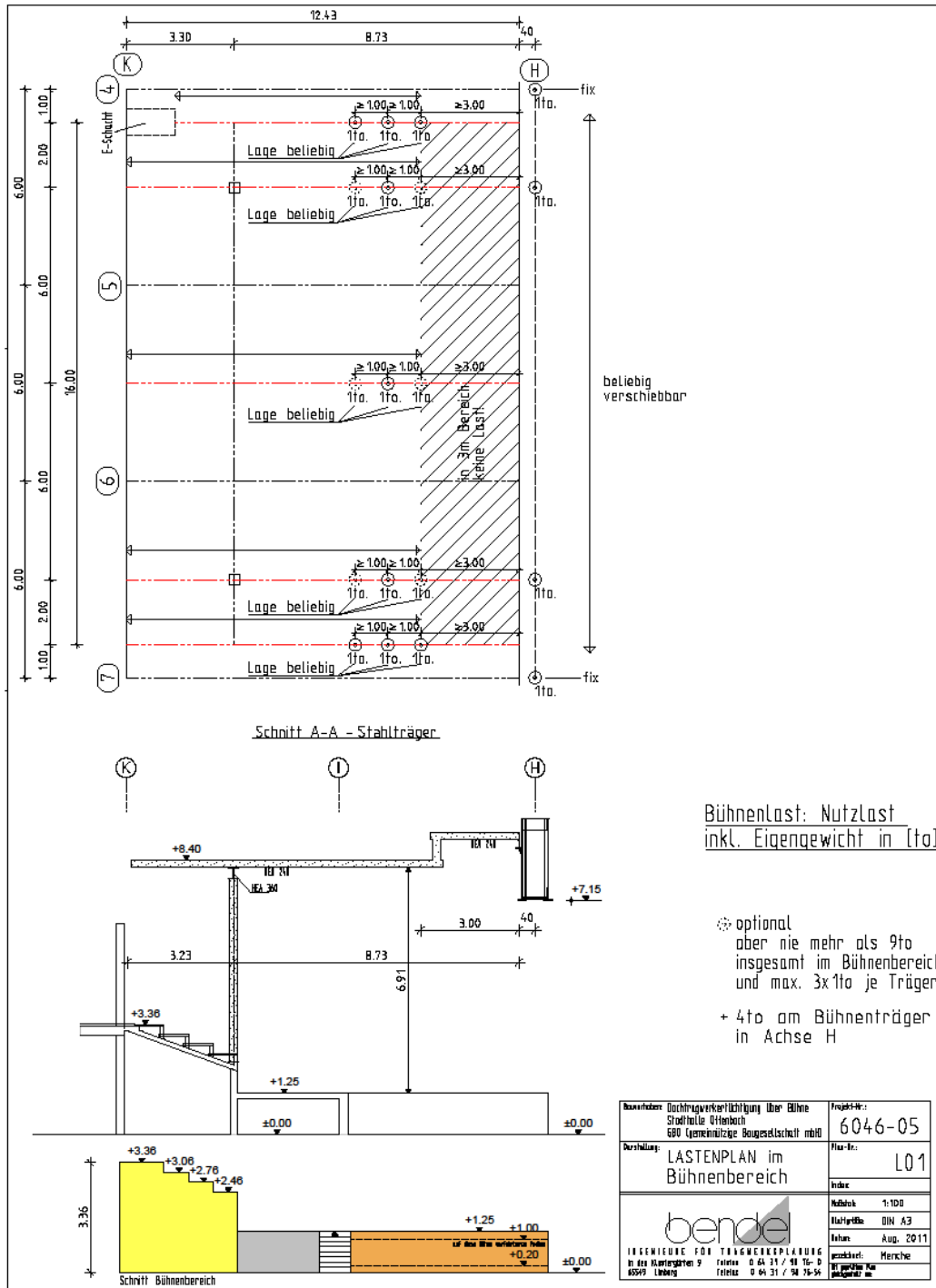



## Stadthalle Offenbach

### Approach:

